

Division Show & Swap PREVIEW

Train Show and Swap Meet



SHAWNEE CIVIC CENTER
13817 Johnson Dr #3802, Shawnee, KS 66216
August 10th 8:30 a.m. - 3:00 p.m.









Home Layout Tours: See the personal layouts of local train Modelers in a variety of scales and completion.



"Ask the Modeler": Get tips and tricks from some of the best modelers in the area



Vendor Tables: See how easy it is to get started on your own layout or diorama.

-  **OVER 60 VENDORS**
-  **2 MODULAR LAYOUTS**
-  **MODEL CONTEST SHOWROOM**
-  **MODEL TRAIN CLINICS**
-  **LAYOUT TOURS THROUGHOUT KC**
-  **"ASK A MODELER" HELP DESK**



SEE MODELER'S PERSONAL LAYOUTS



AMAZING VENDORS

Get your hands on those special trains and tools to get started on your home layout.

DON'T MISS THIS AMAZING EVENT!!



**Sponsored by Turkey Creek Division of
the National Model Railroad Association**

Contact
Superintendent.TurkeyCreekNMRA@gmail.com

Website:
<https://www.tc-nmra.org/>

Facebook:
<https://www.facebook.com/NMRATurkeyCreek>

Vendors & Modular Layouts

Now, Over 75 Vendor Tables

Explore and find that once in a lifetime part for your layout!

4 Modular Layouts on Display

Heartland N-Trak: N scale Club meeting at host Bob Osborn

28'x12' Modular N-Scale club, built to N-Trak module specification. Our club purpose is furtherance and enjoyment of N-Scale Model Railroading through social fellowship, the construction and maintenance of N-Scale layout. We have an open admission policy and are actively seeking new members (18 years and older) regardless of expertise level.

KC T-Nuts: N scale Club meeting at Midwest Model Railroad

24'x11' modular layout with Open modeling on both Era and Locale. Typically groups of modules will promote a specific theme but entire layout is flexible to be open to all modelers in the club. Most modules have full scenery.

Kansas Pacific: 1930s Era 0 & 0-27 Owner Kevin Pyle

4'x16' double dogbone allows for 2 train operations. Lower dogbone has 2 yard tracks and one spur siding.

Topeka Model Railroading Club: HO Modular group in Topeka, KS

28'x16' HO Modular Club promoting a open theme on era and local but mostly focused in Midwest and Western areas. The club is actively showing their modules and open to new members.

2024 TC MEET CONTEST ROOM

Model & Photo Contest

- *by NMRA judging and popular vote.*

The Public will vote on the following Categories:

- **Best of Show**
- **Locomotive**
- **Rolling Stock**
- **Structure**
- **Diorama**
- **Prototype Photo**
- **Model Photo**

1st, 2nd, and 3rd Plaques will be awarded in each Category. Best of Show will be removed from Category to promote more winners.

*Special Youth Award - for the best overall youth (under 18) model entry.
Participation Certificates for ALL Youth entries.*

- **\$25 Gift Voucher:** Each model you enter in the contest will give you a chance in the special drawing to receive a \$25.00 gift voucher at Midwest Model Railroad Hobby Shop. Up to a maximum of three chances.

Schedule

- Awards will be announced @ 2:00 p.m.
- All Models need to be picked up after the awards and by 3:00pm
- Entries will be accepted immediately after opening for the members at 8:00am.
Entries will be accepted after Public Voting starts but you risk missing on their votes if you are very late. Recommend entries by 9:00am.

2024 TC MEET CLINICS



2024 TC Meet Clinics

Brint Jefferis	Upgrading HO Rolling Stock
John Fales	A 3D Printing Primer
Pam MacPhail	Filling Empty Spaces - Part 1
Larry Alfred	Making Stuff
Ray Brown	Lights for Your Layout
Doug Harding	Lumberyards: Prototype study & kitbashing the Atlas Lumberyard

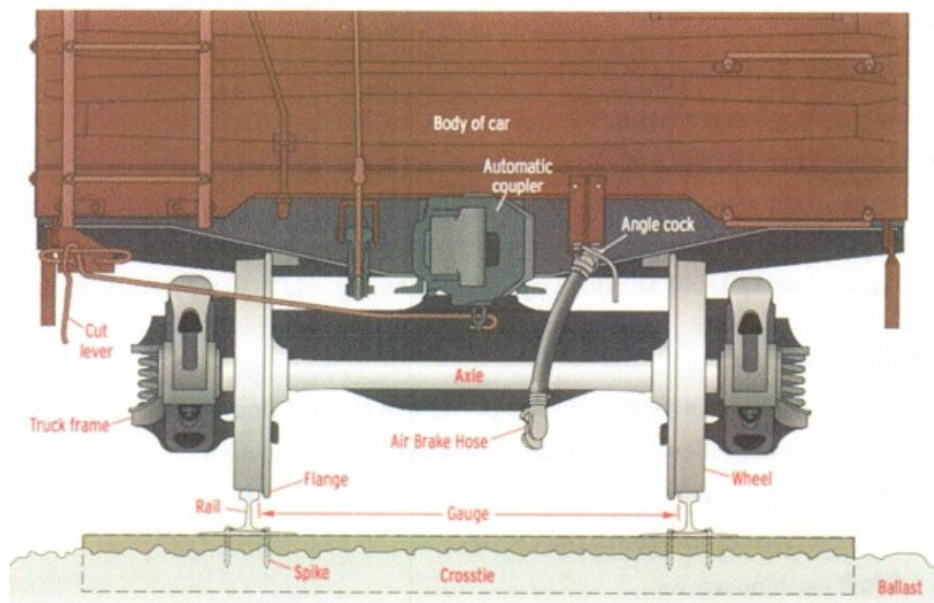

Turkey Creek Division Zone

This year we will host several tables to promote our Division through Key Opportunities:

DIVISION NEWS/INFO:

A chance to learn more about our Division and signing up to the NMRA

ASK THE MODELER:

Bring on any question from both our members and the Public to learn about our Hobby from how to get started to advanced modeling.

DC/DCC Test Station:

Bring that troublesome Loco and will see if we can help discover where to go to get that Locomotive Moving. Whether checking simple DC operation to DCC settings we will do our bests to Test it out.

Time Saver:

Time to test your skills. Are you up to the Challenge! Whether getting throttles in the kids hands or testing your skills we hope our new Division Time Saver gets you operational in running trains!

Layout Tours:

Western Maryland Railway - HO Scale

Dale Phetteplace

Transition Era. 1950 – 1955 time period. Connellsville to Baltimore. Layout size is 25' x 50' in the basement (stairs required). NCE DCC system. The main line runs from Connellsville, PA to Baltimore, MD through Cumberland and Hagerstown, MD. Some of the locations are prototype and some are freelance. Large yards at Elkins, Connellsville, Cumberland, Hagerstown and Baltimore. Several large coal mines at Elkins, WV. Working car float. All engines have sound. Numerous sound modules used for industries and nature. More than 150 handmade turnouts. Numerous craftsmen, kit-bashed and scratch-built structures. Two working turntables. Besides the main Western Maryland Railroad, there are trains from the Baltimore & Ohio, Norfolk & Western and Reading Railroads represented. Some scenery completed.

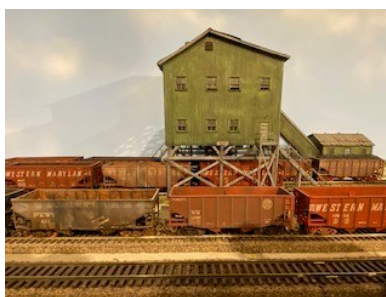



Ken Jenkins' Rock Island Clay Center Line

The HO Scale Rock Island Clay Center Line models the territory between Manhattan Kansas and Belleville Kansas.

The layout is set in the fall of 1969 and the trains move a lot of grain.

The layout is single track "dark territory", and is 57 ft x5 6 ft. around the wall. Stairs come down in the middle of the room. The layout height varies from 46 inches to 56 inches.



Rock Island Clay Center Branch Circa 1969 HO scale

Percentage Complete: 90%
Era Modeled: 1969
Room Size: 28 feet x 54 feet
Benchwork Type: Open Grid
Subroadbed: 1/2-inch Plywood
Backdrop: 1/8-inch Masonite
Curve Radii: 22-inch to 30-inch
Control System: Digitrax DCC
Dispatching: Radio, Waybills
Maximum Grade: 1 1/2%
Turnouts: No. 5 & 6
Track: Code 83 Mains, Code 70 Sidings
Track Height: 46 to 48 inches

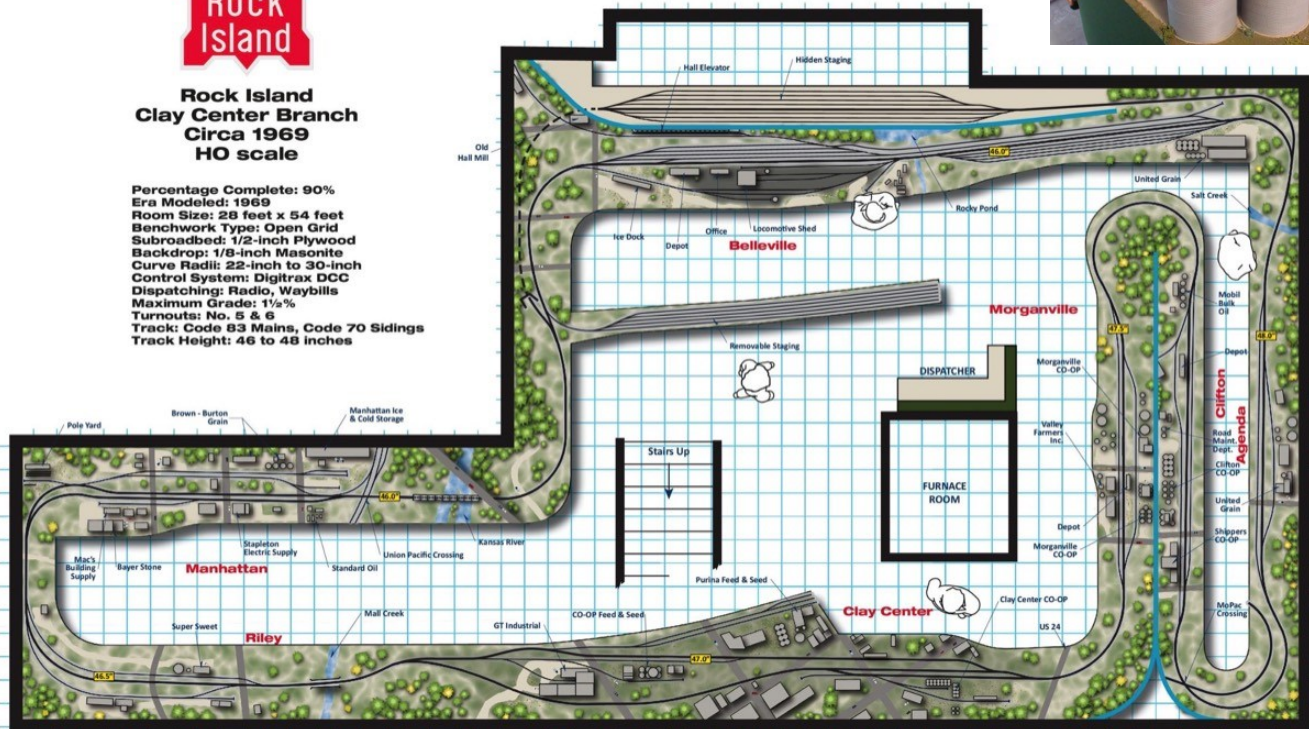

Drawing By Stephen M. Pries, MMR 2016



Upgrading a MoPac SD40-2

August 2016
\$5.95/\$7.95

RAILROAD MODEL CRAFTSMAN

From 48 Ken Jenkins' Rock Island Clay Center Line

Plus

- Page 16 Toronto RPM Meet
- Page 18 Building Repurposed Boxcars
- Page 19 Kitbash a Highway Department Truck
- Page 20 Railroad Signaling VIII

The Kansas City Terminal Railroad

Miles Hale

Miles have has recreated the East and West Bottoms of Kansas City, Missouri. The railroad runs in yard limits, so cuts of cars are moved around the city not trains. The railroad is a switching layout for "city jobs". Miles was a switchman for the Southern Pacific railroad and worked the yards so the railroad is setup to run as the it did in the 1970's.

The KCT is 20' x 24' with a large double end yard with two yard masters and 6 city jobs. Most of the engines are "deadrail" so no stops for lost signals.



RGS & DRGW RR On3 layout Steve McKee

This is a 38'x46' Miles Hale designed freelance railroad based on the RGS & DRGW in southwest Colorado in the San Juan Mountains. It features a beautiful backdrop painted by Larry Patch. This layout is built in the middle of the basement and not around the walls in a 2200sq ft area. There is about 440 ft of track with a minimum radius of 38". Its 220 ft when walking around the layout so there is plenty of room for visitors. The track and # 6 switches are all from San Juan Manufacturing except the 3 way stub switches in the yards which are railway engineering.



Maximum grade is 3 1/2". The elevations go from 45" to 59". The era is the 1950's and will feature mining and a lumber line and will be operational later on. All the rock casting of which there are many are Joel Bragdon's Geodesic Foam scenery using his latex rock castings some of which are 2'x3'. The layout has about 6 year's time in on it so far. I did about 90% of the work on the layout and the rest was help from several friends of mine who helped out when I ran into something I didn't know about yet or something that just took 2 people to do. It features the NCE DCC system for power with wireless throttles. Layout is handicap accessible from walkout basement.



Division Events

Turkey Creek Division Model Train Show & Swap Meet

August 10, 2024

Shawnee Civic Centre
13817 Johnson Drive
Shawnee, Kansas 66216



Show Times 8:30am to 3:00pm, Afternoon Home Layout Tours

Attendees \$12.00 at door ... NMRA members \$10.00 at door
Children 12 and under attend free with accompanying adult.
Family \$20.00 at door Parent and over 13-18 children

Clinics Start at 9:00 — Clinics covering many aspects of the hobby.

Model & Photo Contests — by NMRA judging and popular vote. Each model you entered the contest will give you a chance in the special drawing to receive one a \$25.00 gift voucher, up to a maximum of three chances. Awards will be announced @ 2:00 p.m.

Special Youth Award - for the best overall youth (under 18) model entry.

Door Prizes — From many different manufacturers, vendors, and local hobby shops

Display Layout and Layout Tours — In addition to the display layout at the meet, several local modelers will be opening their homes to layout tours in the afternoon and evening. See the schedule at the show.

Swap Tables and Railroad Groups — Expect to find more than 75 tables from area dealers, local hobbyists, and other railroad groups.

Food and Refreshments — will be available at nominal cost.

-----CUT-----

Turkey Creek Division Annual Train Show 2024 Vendor and Individual Registration Form

Individual or Vendor Name(s) for badges: _____

Address: _____

City: _____ State: _____ Zip: _____ Telephone: _____

E-Mail: _____ **Pre-Registration Cut Off July 1**

Advance Registration: NMRA Member \$8.00 ___ Non-Members \$10.00 ___

Vendor Registration: Six Foot Table/Space: QTY ___ @\$25.00 each _____

Electrical Access (note & 15amp max) \$25.00 ___ Check # _____

NOTE: 1-3 Tables = 1 free Reg, 4-6 Tables = 2 free Reg, 7-9 Tables = 3 free Reg, 10+ Tables = 4 free Reg

Set up from 5:00pm to 9:00pm on August 9th, must be out by 5pm on August 10th.

Make checks payable to "Turkey Creek Division"

Mail to: Turkey Creek Show, c/o Bill Humenczuk, 8624 West 116th Street, Overland Park, KS 66210

Phone 913-338-4478

For more Vendor Information Contact: Ray Brown 913-645-4134, Tstwildcats@hotmail.com

Rev. 2024-04-25